

1. Product Package

- WAP-7500 x 1
- Mounting Kit x 1
- PoE Injector & Power cord x 1
- Grounding Wire with screw x 1
- Water Proof RJ-45 Connector Kit x 1
- Quick Installation Guide (QIG) x 1
- Product CD x 1



1. If any of them are not included or damaged, please contact your local vendor for support.
2. Product CD contains Management Tool, Quick Installation Guide and User Manual.

- 1 -

2. Installation Precautions

1. Users MUST use a proper and well-installed surge arrester and grounding kit with WAP-7500; otherwise, a random lightening could easily cause fatal damage to WAP-7500. **EMD (Lightning) DAMAGE IS NOT COVERED UNDER WARRANTY.**
2. Make sure PoE is correctly connected to the RJ-45 port on the WAP-7500 labeled PoE+Data. **DO NOT CONNECT TO THE PORT LABELED "Warning!! No POE"**, otherwise the WAP-7500 will be severely damaged!
3. Users MUST power off the WAP-7500 first before connecting the external antenna to it; otherwise, damage might be caused to the WAP-7500 itself.

- 2 -

3. System Installation

3.1 Mounting Kit

- Wall/Pole Mounting Bracket
 - 1 T-Form Bracket x 1
 - 2 Articulation Pole x 1
 - 3 Pole Mount Bar x 1
- Fasteners
 - 4 M8×80 Screw x 2, M8×90 Screw x 1
 - 5 M8 Washer x 3
 - 6 M8 Spring Washer x 3
 - 7 M8 Nut x 1
 - 8 M5×16 Screw x 4
 - 9 M5 Washer x 4
 - 10 Wood Screw (for Wall Mount) x 4
 - 11 Wall/Gyprock Plug (for Wall Mount) x 4

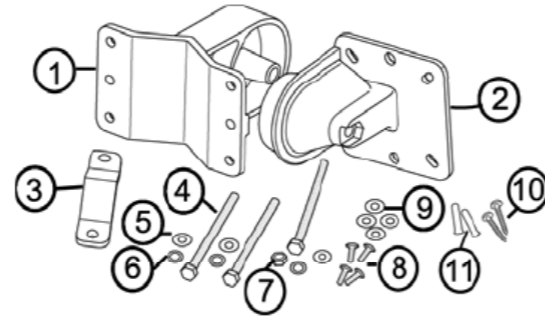

- 3 -

3.2 Waterproof RJ-45 Connector Kit

- Gland x 1
- Sealing Nut x 1
- Sealing x 1

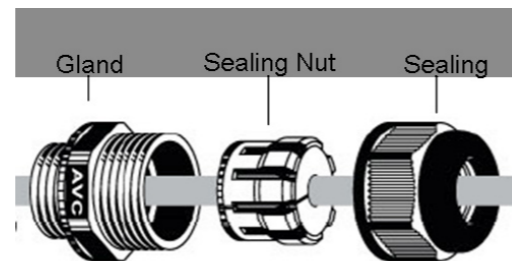

- 4 -

3.3 Assemble the Mounting Bracket

1. Place the main bracket into the seating and use a spanner to fasten the bracket to the WAP-7500 with M5×16 screws ⑧ and M5 washers ⑨ provided in the hardware packets.

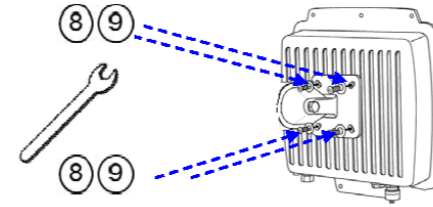

2. Assemble the main bracket by placing articulation pole ② to the T-form bracket ① via a M8×90 ④ screw through the insertion axe and fix with the M8 washer ⑤, spring washer ⑥ and M8 nut ⑦.

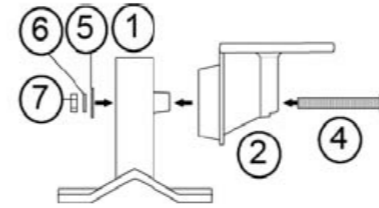

- 5 -

3.4 Pole Mounting

1. Install the main bracket and the pole mount bar ③ over the top of the pole by securing the drill holes of the pole mount bar to the main bracket ones and insert two M8×80 ④ screws, spring washers ⑥ and washers ⑤ through the drill holes and main bracket.
2. Fasten two M8×80 screws ④ and washers ⑤ through the drill holes and main bracket with a spanner.

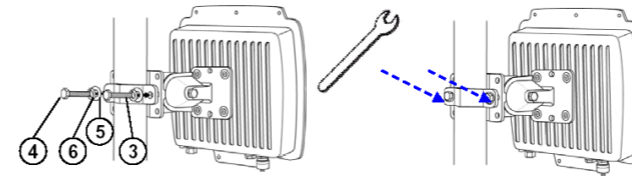

3. Adjust the antenna for appropriate tilt / vertical orientation.

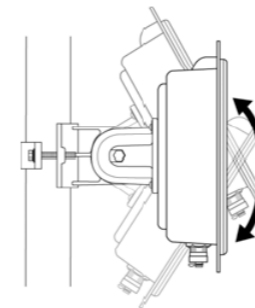

- 6 -

3.5 Connect Up

Before installing the Ethernet cable with a waterproof RJ-45 connector, it is recommended that the Cat-5 RJ-45 coaxial cable be used for the bridge to power injector connections.

1. To connect to the hole labeled **PoE+Data**, open the black cover in advance by using a coin or a slotted screwdriver and then screw in the body of the gland and tighten.



2. Slide the sealing nut to the RJ-45 cable from its middle breach and then insert the sealing into the cable.

Slide the Sealing Nut from its Breach

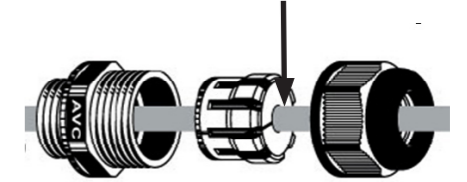

- 7 -

3. Insert the RJ-45 connector and make sure that the locking tab snaps home.

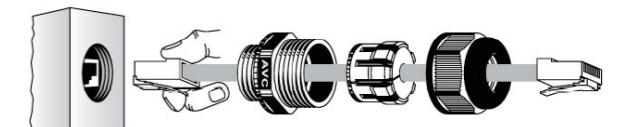

WAP-7500 RJ-45 Port

4. Screw the sealing on the gland and tighten.



- 8 -

3.6 Ground the Wire

The WAP-7500 is shipped with a grounding wire. The unit must be properly grounded to protect against power surges. The grounding point can be found on the bottom of the unit. It is supplied with an appropriate grounding lug for attachment to the WAP-7500.

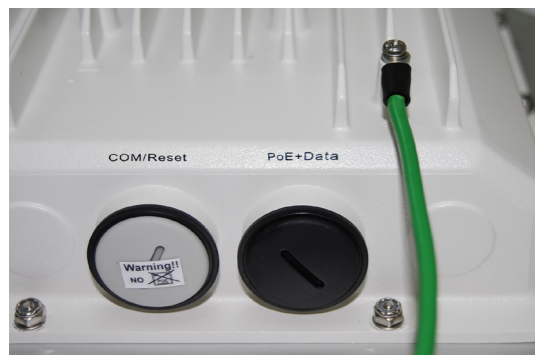

4. Configuration

Connect a PC to the power injector's Ethernet port using a Cat-5 Ethernet cable.

1. Assign a static IP address to your PC which should be in the same network segment with the WAP-7500. As the default IP address of the WAP-7500 is **192.168.1.1**, you may choose from 192.168.1.2 to 192.168.1.254. Then click **OK**.
2. Open the web browser, enter "**https://192.168.1.1/**" in the address bar, and then enter.
3. The default username is "**admin**" and password is "**password**".
 - ◆ Due to browser's security trusted sites, 192.168.1.1 might not be able to be opened. You may choose to continue to the website.

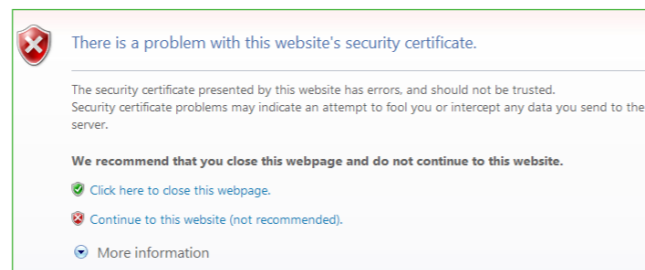

5GHz 802.11a Wireless Outdoor AP/Extender WAP-7500 The Powerful Long Range Wireless Extension

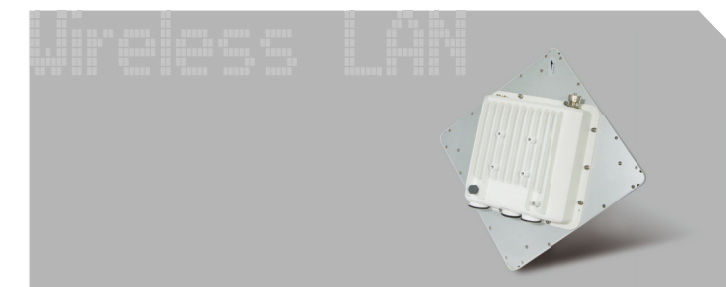

Quick Installation Guide

3.7 Power On

1. Plug an Ethernet cable from your PC into the power injector RJ-45 jack (**DATA IN**); Plug an Ethernet cable from the WAP-7500 into the power injector RJ-45 jack (**P+DATA OUT**).
2. Connect the power module to the power injector and plug the AC cord into an AC power receptacle.
3. After being powered on, the device will send out the beep sound lasting about 1.5 seconds, informing you that the WAP-7500 is powered up! Wait for about 60 seconds the system will be initialized and start working.

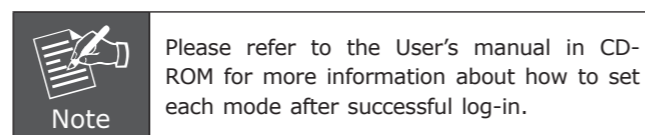
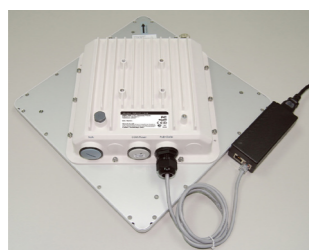

1. Make sure PoE is correctly connected to the RJ-45 port on the WAP-7500 labeled PoE+Data. **DO NOT connect to the port labeled "Warning!! No POE"**, otherwise the WAP-7500 will be severely damaged!
2. When install the secondary antenna, please make sure power off the device to prevent unexpected damage.