

15 meter Infra-Red Camera – CAM-IR138

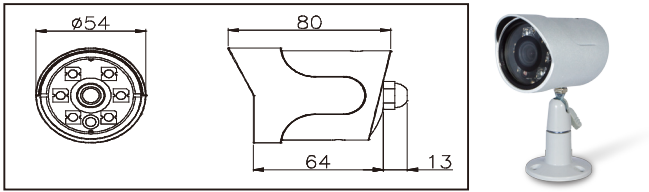

1. Packet Content

1.	CAM-IR138
2.	Screw kit x 1
3.	Rack x 1
4.	Quick Installation Guide x 1

- 1 -

2. Installation

1.	Please fix the CAM-IR138 to a suitable location with the Rack and Screws.
2.	Adjust the camera to the correct direction.
3.	Connect Video Output connector to your DVR.
4.	Connect a DC 12V power adapter to the Power Input connector.
Note	Before connect power adapter to camera, please make sure the power output voltage is DC 12V (max. $\pm 10\%$). If you can not sure this part, we will suggest to use a DC 12V Switching power adapter. It can provide stable power output.

- 2 -

3. Specification

Product	
Model	CAM-IR138
Camera	
Image device	Sony 1/3" CCD
Lens	Board Lens 3.6mm, F1.2 Angle of view H: 71 Degree, V: 52 Degree
Min Illumination	0 lux @ F2.0
Effective Pixels (H x V)	NTSC: 510 x 492, PAL: 500 x 582
IR LED	6 Units of 850nm High Efficiency IR LED
IR Project Distance	15 Meters
Video	
Horizontal Resolution	420 TV lines
S/N Ratio	More than 48 dB

- 3 -

White Balance	Automatic (2300K~10500K)
Gamma Characteristic	0.45
Video Output	1 Vp-p Composite Video / 75 Ohms
Function	
Gain Control	Automatic
Auto Electronic Shutter	NTSC: 1/60s~1/100,000s, PAL: 1/50s~1/110,000s
Synchronous System	Internal, Negative sync
General	
Water Resistance	IP-66
Power Supply	DC 12V, 1A
Operating Temperature	-10 ~ 50 Degree C (14 ~ 122 Degree F)
Dimension ($\Phi \times L$)	54 x 80 mm

- 4 -

Analog Camera
CAM-IR138

www.PLANET.com.tw

15M IR Camera



PLANET Technology Corp.
2011-AB3510-003

