

Powerline Communication

PL-502P

200M PLC + 802.3af PoE Power Adapter



1. Package Contents

Thank you for choosing PLANET 200Mbps Powerline + 802.3af PoE power adapter, PL-502P. "PLC+PoE Adapter" mentioned in this guide refers to the PL-502P and "PLC Adapter" refers to the regular non-PoE powerline adapter.

Open the box of the PL-502P and carefully unpack it. The box should contain the following items:

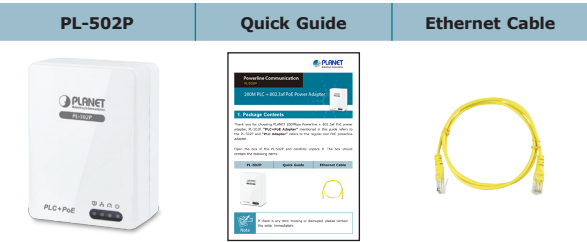

Note If there is any item missing or damaged, please contact the seller immediately.

2. Installation Precautions

- Do not plug this powerline adapter into a powerstrip that has surge protection. Doing so will degrade powerline performance. For best performance, plug all powerline adapters directly into a wall outlet.

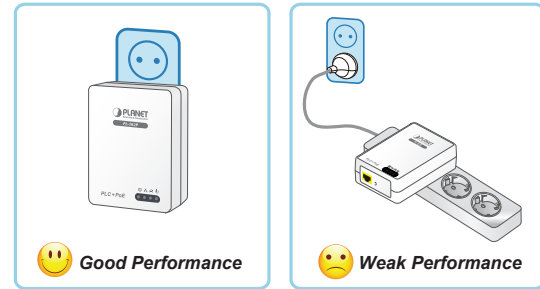

- A maximum of **16** powerline adapters and powerline+PoE adapters can be networked.

3. Application Diagram

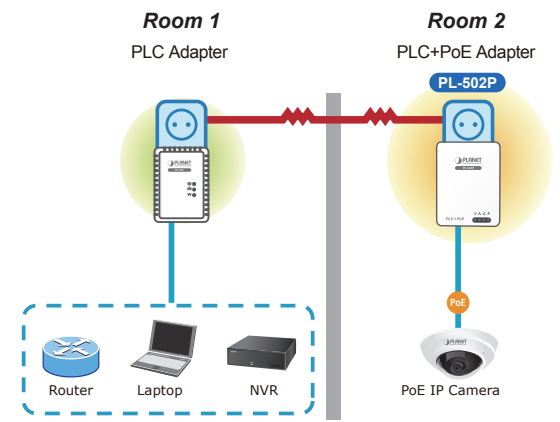

Note Powerline adapter needs to pair with at least one other Powerline compatible device such as this one in order to create a working system.

4. Physical Introduction

Port & Button Descriptions

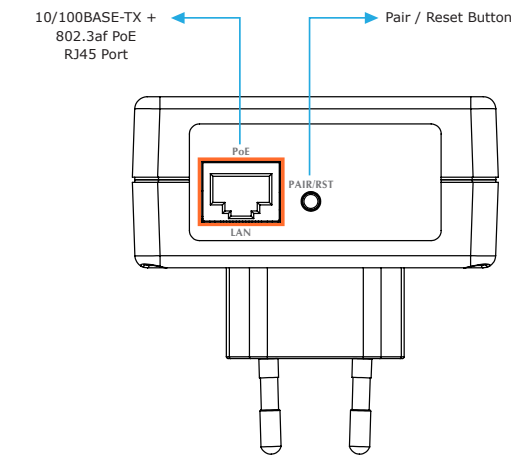

Button	Description
RST (Reset)	Hold the PAIR/RST button down for more than 15 seconds to reset to default setting. The status light will flash once.
PAIR	Press the PAIR/RST button for 1~3 seconds to join another Powerline network.

LED Descriptions

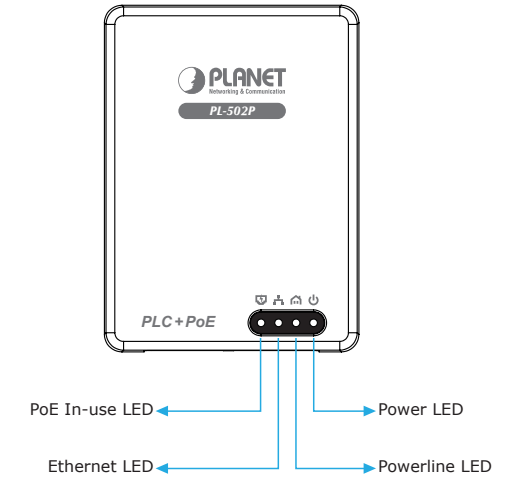

LED Definition

LED	Status	Description
Power	On	Steady on to indicate the PL-502P is connected to the power outlet
	Off	Power off
	Flashing	The LED that flashes in every 15 seconds indicates the PL-502P is in standby mode.

Icon	LED Status	Description
Powerline	Off	This Powerline adapter is not connected.
	Red	Minimum connection to indicate weak signal and slower network speed: less than 50Mbps
	Orange	Normal signal with standard network speed: 50-99Mbps
	Green	Excellent signal with optimal network speed: 100Mbps+
	Flashing Green	1 second ON, 4 seconds OFF: Powerline in standby mode
Ethernet	Green	Steady on to indicate the RJ45 port has correctly connected to the Ethernet port of your IP camera or wireless access point.
	Blinking	The PL-502P is actively sending or receiving data over the Ethernet port.
	Off	Ethernet Link not active
PoE In-use	Green	Connected PoE device detected as power is needed. Port is supplying PoE.
	Off	Connected PoE device detected as power is not needed. Port is not supplying PoE.

5. Hardware Installation

To create a powerline + PoE network, simply connect the **PLC Adapter** and **PLC+PoE Adapter**, the **PL-502P**, to AC wall power outlets that are on the same electrical system. No additional configuration in the powerline network is necessary.

Follow the steps below to install the PL-502P in the house

- Step 1:**
1. Plug the **PLC Adapter** into AC wall power outlets near the device you want to connect.
 2. Plug the **PL-502P** into AC wall power outlet in your room or office where you want to install the **PoE PD**, such as IP camera or PoE wireless access point.
 3. Ensure the Power LEDs are on.

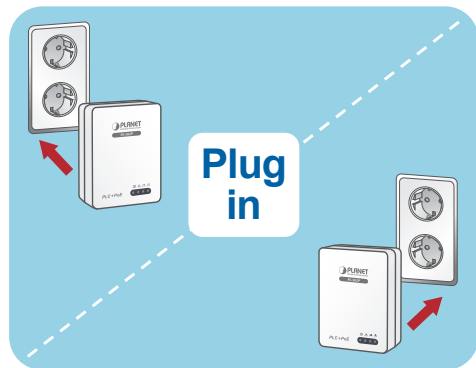

Step 2: To secure your powerline network:

1. Hold down the PAIR/RST (or Security) button for 1~3 seconds on the first **PLC Adapter**.
2. Within 2 minutes, hold down the **PAIR/RST** button for **1~3 seconds** on the **PL-502P**.
3. The Power LED starts to blink.
4. After successful setup, the **Power LED** will remain solid and the **Powerline LED** will start blinking.

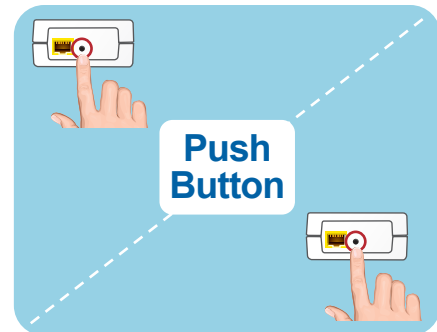

Within 2 minutes

- Step 3:**
1. Connect the Ethernet port of **PLC Adapter** to your home router, NVR (Network Video Recorder) or PC's Ethernet port via the UTP cable.
 2. Connect the PoE Ethernet port of the **PL-502P** to the PoE PD via the UTP cable.

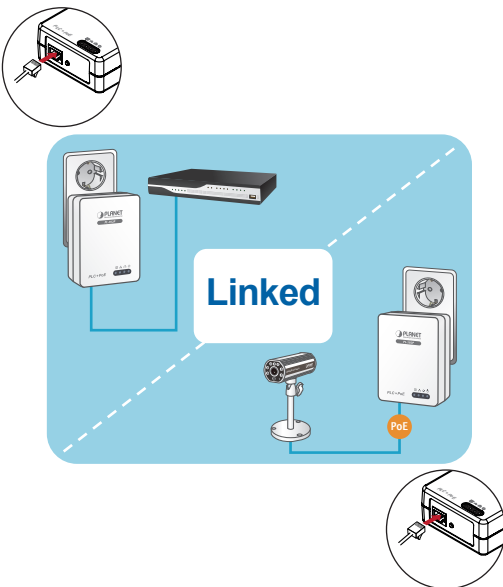

The **PoE LED** of the PL-502P should light up first and then the **Ethernet LED** should start flashing in **green**.

- Step 4:** Verify the LEDs' status of the **PL-502P**. If your PoE PD is successfully powered up and can establish the Ethernet data link with remote PC or NVR, then that means the remote **PLC Adapter** and the PL-502P work fine.

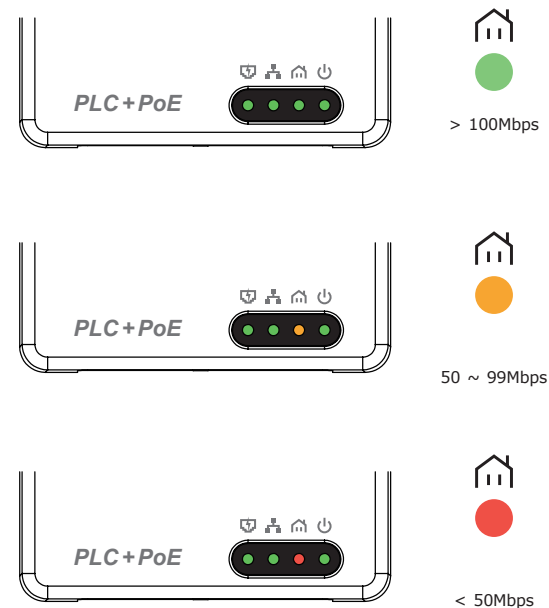

Your PLC+PoE Adapters are now connected forming a powerline (HomePlug AV) network.

6. Utility Installation for Windows

PLANET **Power Packet Utility** is a software utility used to search and make connecting on a powerline network quick and simple.

The installation procedure for the **Power Packet Utility** will vary depending on which operating system you are using on your computer. The following procedure is for installation under Windows 7. Installation of other operating systems is similar.

- Step 1:** Download the Power Packet Utility from PLANET download URL
<http://www.planet.com.tw/en/support/download.php?type1=320&model=48619&type=8184#list>

- Step 2:** The file you have downloaded is a zip file. Unzip it and double-click on the "Setup.exe" executable file to begin installation.

- Step 3:** The utility will be installed on your computer and a new icon "Power Packet Utility" will appear on your desktop.



- Note** This utility is only for Windows 2000, 2003, XP, Vista, Windows 7 and Windows 8.

Further Information:

The above steps introduce the simple installations of the PL-502P. For further details on the installation of the PLC+PoE Adapters, please refer to the user manual which you can download from the PLANET website.

<http://www.planet.com.tw/en/support/download.php?type1=320&model=48619&type=3>



If you have further questions, please contact the local dealer or distributor where you purchased this product or you can contact PLANET directly at the following email address: support@planet.com.tw